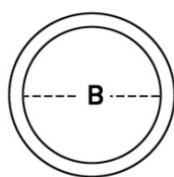
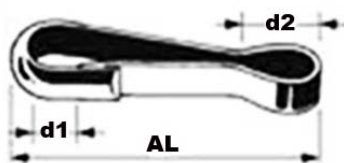
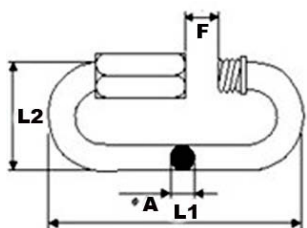

Kroužek svařovaný pozink

Skladový kód	Povrch	Ø	B	nostnost/kg	Ks/baleni	Kg/100ks	Kč/100ks
1269.032	zn	3	20	30	100	0,350	102,-
1269.035	zn	4	25	40	100	0,670	126,-
1269.043	zn	4	30	60	100	0,950	146,-
1269.053	zn	5	30	100	100	1,700	228,-
1269.054	zn	5	40	100	100	2,050	278,-
1269.064	zn	6	40	150	100	3,000	366,-
1269.065	zn	6	50	150	100	3,600	421,-
1269.073	zn	7	35	200	50	3,700	439,-
1269.075	zn	7	50	200	50	5,100	553,-
1269.085	zn	8	50	300	50	6,800	755,-
1269.086	zn	8	60	300	50	8,000	863,-
1269.088	zn	8	80	300	25	10,600	1 027,-
1269.105	zn	10	50	500	25	10,800	1 033,-
1269.108	zn	10	80	500	20	17,200	1 919,-
1269.126	zn	12	60	800	10	18,900	1 700,-
1269.130	zn	12	100	800	10	30,000	2 583,-

Karabina simplex nikel

Skladový kód	Povrch	AL	d1	d2	nostnost/kg	Ks/baleni	Kg/100ks	Kč/100ks
2403.030	nikl	30	8	6	10	200	0,220	69,-
2403.040	nikl	40	9	8	20	100	0,430	139,-
2403.050	nikl	50	11	10	40	100	0,850	227,-
2403.060	nikl	60	13	11	70	50	1,560	340,-

Článek Rapid pozink

Skladový kód	Povrch	A	L1	L2	F	nostnost/kg	Ks/baleni	Kg/100ks	Kč/100ks
2537.003	zn	3,5	36	17	5	100	50	0,900	308,-
2537.004	zn	4	40	20	6	200	50	1,200	354,-
2537.005	zn	5	49	23	7	300	50	2,100	464,-
2537.006	zn	6	58	27	8	400	50	3,300	564,-
2537.007	zn	7	66	30	8	550	25	5,100	753,-
2537.008	zn	8	76	34	10	700	25	7,200	983,-
2537.009	zn	9	82	36	11	900	20	9,600	1 301,-
2537.010	zn	10	90	40	12	1100	20	13,200	1 669,-
2537.012	zn	12	107	48	15	1500	10	21,400	2 824,-
2537.014	zn	14	125	55	17	2200	5	37,700	5 932,-

Hák houpačkový kyvný s vrutem pozink

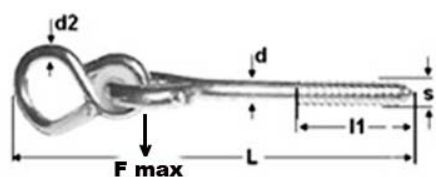

Skladový kód	Povrch	L	l1	d	d2	s	F max	Ks/baleni	Kg/100ks	Kč/100ks
1282.180	zn	180	75	10,6	8,0	12,4	150	10	23,600	2 719,-

Hák houpačkový kyvný se závitem pozink

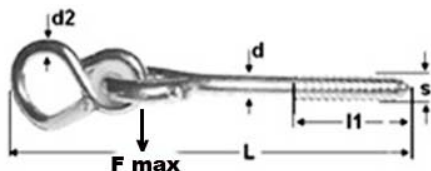

Skladový kód	Povrch	L	závit	l1	d2	d	F max	Ks/baleni	Kg/100ks	Kč/100ks
1283.180	zn	200	M12	100	8	10,6	150	10	26,500	2 867,-
1283.250	zn	250	M12	150	8	10,6	150	10	32,200	3 235,-

Hák houpačkový kyvný s karabinou pozink

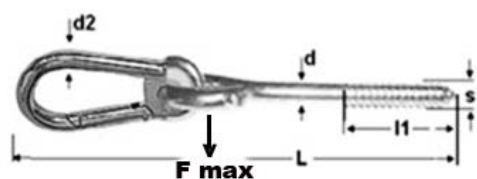

Skladový kód	Povrch	L	závit	l1	d2	d	F max	Ks/baleni	Kg/100ks	Kč/100ks
1284.230	zn	230	vrut	75	10	10,6	250	10	23,500	3 356,-
1284.280	zn	280	M12	150	10	10,6	250	10	33,200	3 920,-

Objímka houpačková s karabinou pozink

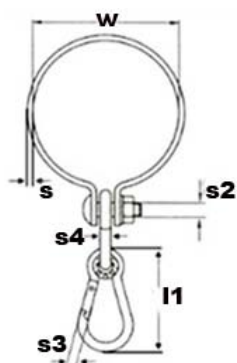

Skladový kód	Povrch	w	s2	l1	s	s4	F max	Ks/baleni	Kg/100ks	Kč/100ks
1285.050	zn	50	M10	100	3,0	7,8	150	5	36,400	4 841,-
1285.080	zn	80	M10	100	3,0	7,8	150	5	42,400	5 829,-
1285.100	zn	100	M10	100	3,5	7,8	150	5	53,000	6 070,-
1285.120	zn	120	M10	100	3,5	7,8	150	5	62,100	7 387,-

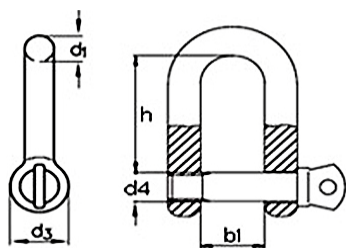
Třmen rovný typ D pozink

Skladový kód	Povrch	d1	d4	d3	b1	h	nostnost	Ks/baleni	Kg/100ks	Kč/100ks
4447.05	zn	5	5	10	10	20	80	50	1,500	330,-
4447.06	zn	6	6	12	12	24	120	50	2,500	381,-
4447.08	zn	8	8	16	16	32	200	50	5,500	599,-
4447.10	zn	10	10	20	20	40	320	50	11,000	869,-
4447.12	zn	12	12	24	24	48	500	25	19,000	1 382,-
4447.14	zn	14	14	28	28	56	650	10	32,000	2 171,-
4447.16	zn	16	16	32	32	64	800	10	42,000	2 835,-
4447.19	zn	19	19	38	38	76	1100	5	85,000	5 211,-
4447.22	zn	22	22	44	44	88	1500	1	124,00	7 501,-
4447.25	zn	25	25	50	50	100	2000	1	183,00	10 665,-
4447.28	zn	28	28	56	56	112	3000	1	255,00	16 322,-
4447.32	zn	32	32	64	64	128	4000	1	378,00	22 880,-

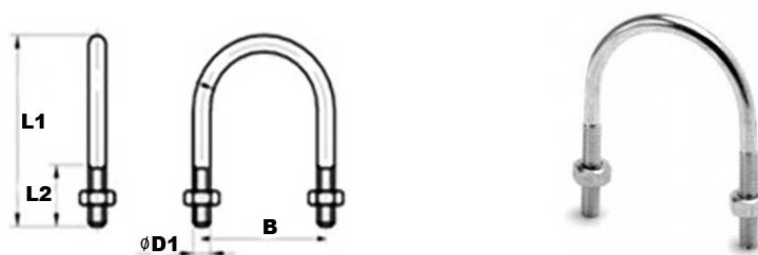
Třmen potrubní ERT pozink

Skladový kód	Povrch	D1	L1	L2	B	rosah	Ks/baleni	Kg/100ks	Kč/100ks
5120.025	zn	M6	38	20	25	12-17	100	1,820	212,-
5120.030	zn	M6	45	30	30	15-21	100	2,100	245,-
5120.035	zn	M8	60	30	35	20-27	100	4,300	428,-
5120.042	zn	M8	67	30	42	26-34	100	5,450	491,-
5120.056	zn	M8	76	35	56	33-42	50	6,250	556,-
5120.057	zn	M8	82	35	57	40-49	50	6,600	600,-
5120.071	zn	M8	90	35	71	50-60	50	7,450	958,-
5120.083	zn	M10	105	40	83	60-70	50	14,000	1 148,-
5120.090	zn	M10	117	45	90	66-76	25	15,300	1 261,-
5120.093	zn	M10	120	45	93	70-82	25	15,500	1 283,-
5120.100	zn	M10	123	45	100	80-90	25	16,100	1 318,-
5120.118	zn	M12	155	50	118	90-102	20	28,500	2 149,-
5120.121	zn	M12	160	55	121	100-108	20	29,300	2 209,-
5120.135	zn	M12	160	55	135	102-114	20	29,800	2 282,-
5120.142	zn	M12	170	55	142	121-127	15	31,500	2 487,-
5120.145	zn	M12	180	65	145	126-133	15	32,800	2 614,-
5120.157	zn	M14	190	70	157	131-140	10	47,900	4 636,-
5120.170	zn	M14	200	70	170	143-153	5	50,400	4 887,-
5120.175	zn	M14	208	70	175	150-159	5	53,200	4 968,-

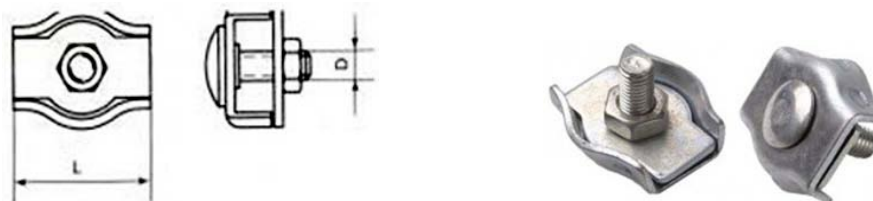
Svorka lanová Simplex pozink

Skladový kód	Povrch	L	D	lano Ø	Ks/baleni	Kg/100ks	Kč/100ks
3428.02	zn	15	M4	2	100	0,500	124,-
3428.03	zn	17	M4	3	100	0,700	143,-
3428.04	zn	20	M5	4	50	1,100	200,-
3428.05	zn	25	M5	5	50	1,500	232,-
3428.06	zn	30	M6	6	50	2,200	300,-
3428.08	zn	37	M8	8	20	4,800	583,-

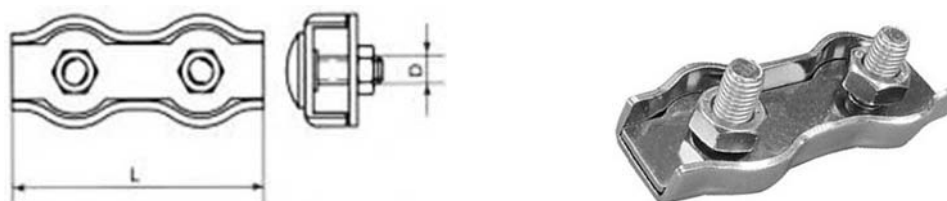
Svorka lanová Duplex pozink

Skladový kód	Povrch	L	D	lano Ø	Ks/baleni	Kg/100ks	Kč/100ks
3429.02	zn	30	M4	2	50	1,000	213,-
3429.03	zn	35	M4	3	50	1,350	243,-
3429.04	zn	40	M5	4	50	2,300	321,-
3429.05	zn	50	M5	5	25	3,100	402,-
3429.06	zn	60	M6	6	25	4,600	505,-
3429.08	zn	75	M8	8	10	9,800	1 121,-

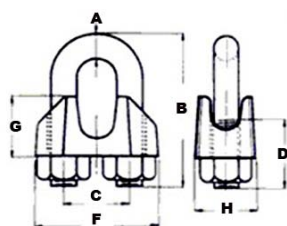
Svorka lanová DIN 741 pozink

Skladový kód	Povrch	B	C	D	F	lano Ø	závit	Ks/baleni	Kg/100ks	Kč/100ks
3426.03	zn	20	9	12	21	3	M4	100	0,850	103,-
3426.05	zn	24	11	13	23	5	M5	100	1,300	127,-
3426.06	zn	28	13	15	26	6,5	M5	100	1,650	151,-
3426.08	zn	34	16	19	30	8	M6	50	2,700	224,-
3426.10	zn	42	19	22	34	10	M8	50	5,700	402,-
3426.11	zn	44	20	22	36	11	M8	25	6,000	427,-
3426.13	zn	55	24	30	42	13	M10	20	10,800	764,-
3426.14	zn	57	25	30	44	14	M10	20	11,000	815,-
3426.16	zn	63	29	33	50	16	M12	10	17,800	1 166,-
3426.19	zn	75	32	38	54	19	M12	10	22,400	1 463,-
3426.22	zn	85	37	44	61	22	M14	5	34,900	2 149,-
3426.26	zn	95	41	45	65	26	M14	5	40,300	2 522,-
3426.30	zn	110	48	50	74	30	M16	1	60,300	3 761,-
3426.34	zn	120	52	55	80	34	M16	1	73,600	4 587,-
3426.40	zn	140	58	60	88	40	M16	1	92,500	5 559,-

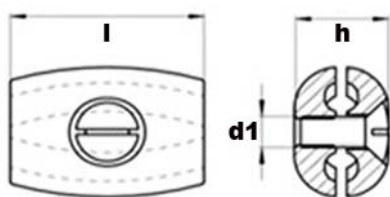
Svorka lanová plochá pozink

Skladový kód	Povrch	l	h	d1	lano Ø	Ks/baleni	Kg/100ks	Kč/100ks
3427.02	zn	28	11	M5	2	50	1,600	578,-
3427.03	zn	28	12	M5	3	50	1,600	578,-
3427.04	zn	34	14	M6	4	25	3,600	1 115,-
3427.05	zn	34	15	M6	5	25	4,000	1 154,-
3427.06	zn	35	15	M6	6	25	4,500	1 217,-

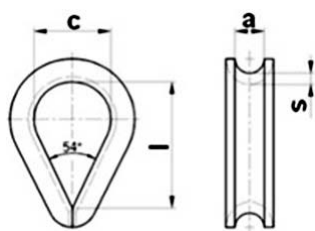
Očnice DIN 6899B pozink

Skladový kód	Povrch	a	l	c	s	lano Ø	Ks/baleni	Kg/100ks	Kč/100ks
3459.03	zn	4	19	12	1,0	3	100	0,500	145,-
3459.04	zn	5	21	13	1,0	4	100	0,700	167,-
3459.05	zn	6	23	14	1,0	5	100	0,900	200,-
3459.06	zn	7	25	16	1,3	6	100	1,400	224,-
3459.07	zn	8	28	18	1,3	7	50	1,900	321,-
3459.08	zn	9	32	20	1,5	8	50	2,600	321,-
3459.10	zn	11	38	24	1,5	10	25	3,500	500,-
3459.12	zn	13	48	30	2,0	12	20	6,200	707,-
3459.14	zn	15	51	32	2,0	14	20	8,800	999,-
3459.16	zn	17	58	36	2,5	16	10	12,800	1 304,-
3459.18	zn	19	64	40	2,5	18	5	18,000	2 001,-
3459.20	zn	21	72	45	3,0	20	5	25,000	2 500,-
3459.22	zn	23	80	55	3,0	22	1	31,500	2 948,-
3459.24	zn	26	90	56	4,0	24	1	43,000	4 509,-
3459.26	zn	28	99	62	5,0	26	1	57,000	5 262,-
3459.28	zn	30	112	70	5,0	28	1	66,000	6 338,-
3459.30	zn	32	120	75	6,0	30	1	85,000	8 785,-
3459.32	zn	34	128	80	6,0	32	1	95,000	9 784,-
3459.34	zn	36	152	95	6,0	34	1	107,00	12 232,-
3459.36	zn	38	160	100	8,0	36	1	144,00	13 123,-
3459.38	zn	40	176	110	8,0	38	1	164,00	15 684,-
3459.40	zn	43	184	115	10,0	40	1	267,00	23 351,-
3459.42	zn	45	192	120	10,0	42	1	305,00	26 243,-
3459.45	zn	48	240	150	10,0	45	1	342,00	38 918,-

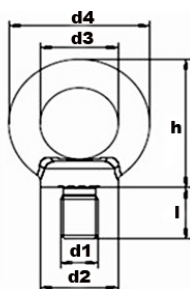
Šroub závěsný DIN 580 pozink

Skladový kód	Povrch	d1	d3	d4	l	nostnost kg		Ks/baleni	Kg/100ks	Kč/100ks
						0°/ 45 °				
4580.06	zn	M6	36	20	13	70/50		25	5,500	697,-
4580.08	zn	M8	36	20	13	140/95		25	6,000	697,-
4580.10	zn	M10	45	25	17	230/170		20	11,000	1 095,-
4580.12	zn	M12	54	30	20	340/240		15	18,000	1 493,-
4580.14	zn	M14	63	35	27	340/240		10	26,000	1 987,-
4580.16	zn	M16	63	35	27	700/500		10	28,000	2 242,-
4580.20	zn	M20	72	40	30	1200/830		5	45,000	3 337,-
4580.24	zn	M24	90	50	36	1800/1270		1	74,000	7 020,-
4580.30	zn	M30	108	60	45	3600/2800		1	166,00	14 625,-
4580.36	zn	M36	126	70	54	5100/3700		1	265,00	22 698,-
4580.42	zn	M42	144	80	63	7000/5000		1	403,00	40 716,-
4580.48	zn	M48	165	90	68	8600/6100		1	638,00	77 220,-

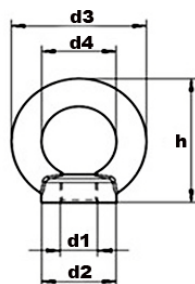
Matice závěsná DIN 582 pozink

Skladový kód	Povrch	d1	d3	d4	h	nostnost kg		Ks/baleni	Kg/100ks	Kč/100ks
						0°/ 45 °				
4582.06	zn	M6	36	20	36	70/50		25	5,000	697,-
4582.08	zn	M8	36	20	36	140/95		25	5,000	697,-
4582.10	zn	M10	45	25	45	230/170		20	9,000	1 095,-
4582.12	zn	M12	54	30	53	340/240		15	16,000	1 493,-
4582.14	zn	M14	63	35	62	340/240		10	24,000	1 987,-
4582.16	zn	M16	63	35	62	700/500		10	24,000	2 242,-
4582.20	zn	M20	72	40	71	1200/830		5	36,000	3 337,-
4582.24	zn	M24	90	50	90	1800/1270		1	72,000	7 020,-
4582.30	zn	M30	108	60	109	3600/2800		1	132,00	14 625,-
4582.36	zn	M36	126	70	128	5100/3700		1	208,00	22 698,-
4582.42	zn	M42	144	80	147	7000/5000		1	311,00	40 716,-
4582.48	zn	M48	165	90	168	8600/6100		1	502,00	77 220,-

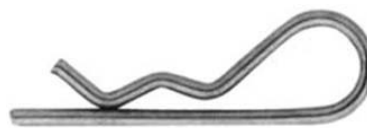
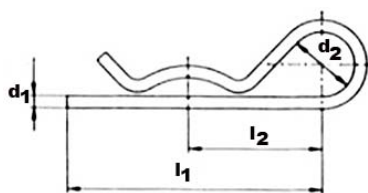
Závlačka pružinová jednoduchá DIN 11024 pozink

Skladový kód	Povrch	d1	l1	l2	d2	rozsah/mm	Ks/baleni	Kg/100ks	Kč/100ks
1261.02	zn	2	42	24	12	8-14	100	0,270	84,-
1261.03	zn	3	62	35	18	10-16	100	0870	129,-
1261.04	zn	4	64	35	20	16-20	50	1,520	187,-
1261.05	zn	5	86	50	26	22-28	50	3,300	310,-
1261.06	zn	6	102	55	32	28-40	50	5,900	577,-
1261.07	zn	7	108	62	32	28-45	25	8,000	587,-
1261.08	zn	8	120	62	32	30-45	10	11,500	975,-

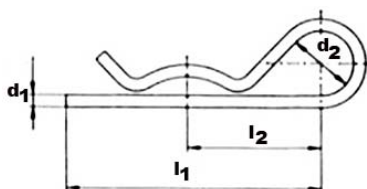
Závlačka pružinová dvojitá DIN 11024 pozink

Skladový kód	Povrch	d1	l1	l2	d2	rozsah/mm	Ks/baleni	Kg/100ks	Kč/100ks
1262.02	zn	2	38	20	10	8-14	100	0,330	121,-
1262.03	zn	3	63	34	17	14-20	100	1,080	197,-
1262.04	zn	4	75	45	21	17-24	50	2,420	345,-
1262.05	zn	5	90	53	27	18-30	50	4,650	534,-
1262.06	zn	6	122	72	30	24-36	25	9,400	965,-
1262.07	zn	7	125	70	30	26-40	10	12,300	1 358,-

Oko lešenářské pozink

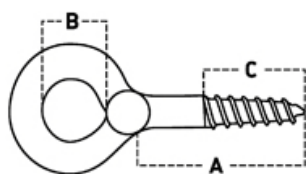

Skladový kód	Obj. značka	Povrch	Ø	A	B	C	Ks/baleni	Kg/100ks	Kč/100ks
022.11.08008	22S/80x22x7,8	zn	7,8	80	22,0	45	25	5,840	1 500,-
022.11.10008	22S/100x22x7,8	zn	7,8	100	22,0	50	25	6,540	1 600,-
022.11.12008	22S/120x22x7,8	zn	7,8	120	22,0	55	25	7,280	1 700,-

Obrtlík pozink

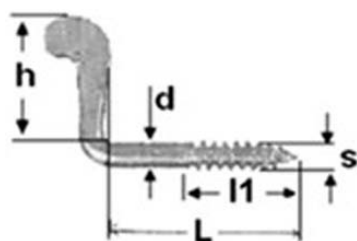

Skladový kód	Povrch	L	d	l1	h	Hmoždinka	Ks/baleni	Kg/100ks	Kč/100ks
1268.030	zn	30	3,9	18	22	6	100	0,520	260,-
1268.040	zn	40	4,4	23	29	6	50	0,880	323,-
1268.050	zn	50	5,2	30	32	8	50	1,200	410,-